

# S6102

1998.5-2002 DODGE 2500/3500 5.9L  
CUMMINS (4WD ONLY), TURBO-BACK,  
4" COOL DUALS™

# MBRP

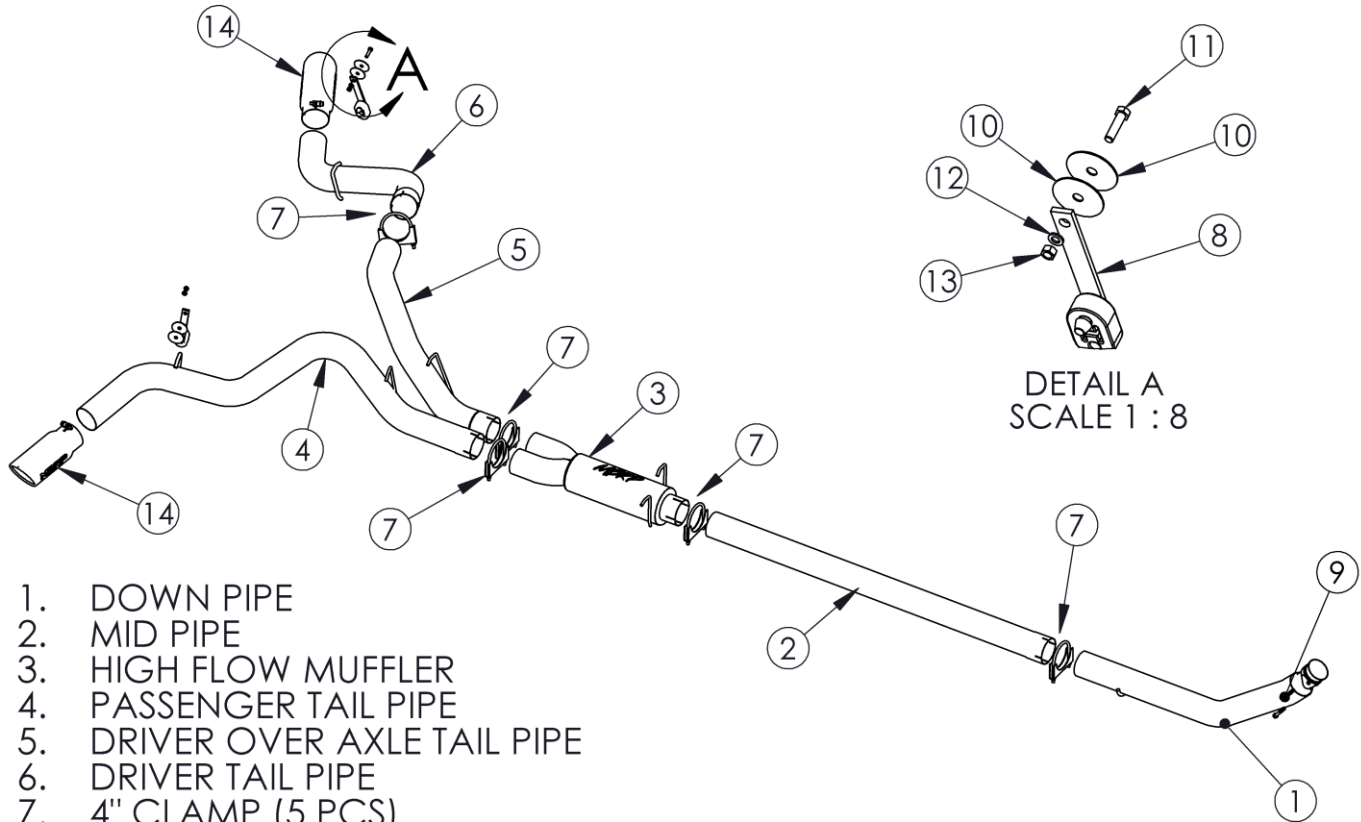

1. DOWN PIPE
2. MID PIPE
3. HIGH FLOW MUFFLER
4. PASSENGER TAIL PIPE
5. DRIVER OVER AXLE TAIL PIPE
6. DRIVER TAIL PIPE
7. 4" CLAMP (5 PCS)
8. HANGER ASSEMBLY (2 PCS)
9. FENDER WASHER 3/8" (4 PCS)
10. LOCK WASHER 3/8" (2 PCS)
11. HEX BOLT 3/8" X 1-1/2" (2 PCS)
12. NUT 3/8" (2 PCS)
13. HEX BOLT - M10 X 60mm (2 PCS)
14. EXHAUST TIP (2 PCS)

## PLEASE READ BEFORE STARTING INSTALLATION

While MBRP Inc. has made every effort to ensure that all components of this system are of superior quality and properly packaged, it is the installer's responsibility to ensure the following before removal of the factory exhaust:

- that ALL components shown above are present.
- that ALL mating components fit together.
- that there are no damaged components.
- that the system you have purchased is appropriate for your vehicle year, model and configuration.
- that the system will not interfere with any modifications previously installed or planned.
- that you have read and understand these instructions.

If you have any questions or are uncertain about any aspect of the installation of this system to your vehicle please contact your dealer before commencing installation.

# MBRP

## Removal of Stock System:



Figure 1

1. Separate the stock exhaust system at the slip joint by the muffler. Remove the rear exhaust from the rubber hangers and remove the system from under the truck.
2. Using a 15mm socket or wrench, remove the two (2) bolts at the turbo flange and remove the stock system.

## Installation of MBRP Inc. Performance Exhaust:



Figure 2

1. Install the **Down Pipe** starting from behind the cross member and place it in the same position as the stock down pipe. Place the hanger into the OEM rubber insulator and attaching the flared end to the turbo using the supplied **M10 x 60mm Bolts**. Do not fully tighten until all components are in place. **Refer to Figures 1 & 2.**
2. Install the **Extension Pipe** over the **Down Pipe**. The **Extension Pipe** may require cutting accommodate vehicles other than the Quad Cab long bed. (**Installation tip:** Temporarily hang the **Muffler** into the two OEM rubber hangers and measure from the muffler to the **Down Pipe** to determine the length required.) **Refer to Figure 3.**



Figure 3

# MBRP



**Figure 4**



**Figure 5**



**Figure 6**



**Figure 7**



**Figure 8**

3. Install the **Muffler** onto the **Extension Pipe** and into the OEM rubber hangers above the inlet. **Refer to Figure 4.**
4. Install the **Over Axle Pipe** onto the **Muffler** outlet closest to the drive shaft. Insert the hanger on the **Over Axle Pipe** into the OEM rubber hanger located directly above the **Muffler** outlet.
5. Install the **Driver Side Tail Pipe** by feeding it around the outside of the shock and connecting it to the **Over Axle Pipe**. **Refer to Figure 6.**
6. Using the factory hole located in the frame, found directly above the **Tail Pipe** hanger, attach the **Rubber Hanger** provided using the supplied hardware. Hang the **Tail Pipe** using the installed **Rubber Hanger**.
7. Install the **Passenger Side Tail Pipe** onto the remaining **Muffler** outlet.
8. Using the factory hole located in the frame, found directly above the **Tail Pipe** hanger, attach the **Rubber Hanger** provided using the supplied hardware. Hang the **Tail Pipe** using the installed **Rubber Hanger**. **Refer to Figure 7.**
9. Install and adjust **Exhaust Tips** to suit. Use a 17mm wrench to tighten the lock bolt located on each **Exhaust Tip**.
10. Install the provided **Clamps** around the pipes where required. Check along the whole length of the exhaust system to ensure there is adequate clearance around the fuel and brake lines or any wiring. If any interference is detected, relocate or adjust. Tightening all connections.

**Congratulations!** You are ready to begin experiencing the improved performance and driving pleasure of your MBRP Inc. performance exhaust system. We know you will enjoy your purchase.